

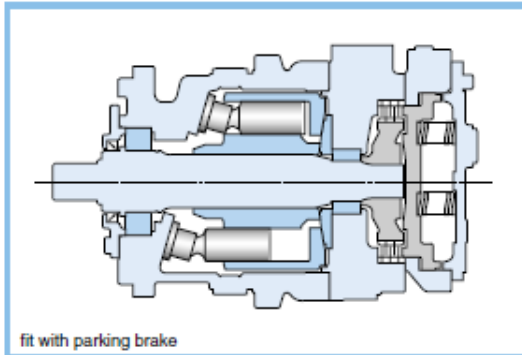

Fixed-Displacement Type Axial Piston Motor

M3X Series



The M3X series are newly developed motors for construction machinery, industrial machinery or other applications.

The design based on technology and experience of current MX series is more compact and enables a speed range.

M3X 530 - A C N - 501A

Size : 530 cm³

optional function code : A: Standard

shaft code: JIS involute spline (external)

Direction of rotation: N clockwise rotation (standard)

model	capacity (☆ : standard)				
M3X530	Vg	☆ 533	499	(485)	467
	η max.	1,400	1,400	1,420	1,450

Scan QR code to
download our vCard



DIMENSIONS

[M3X***ACN]

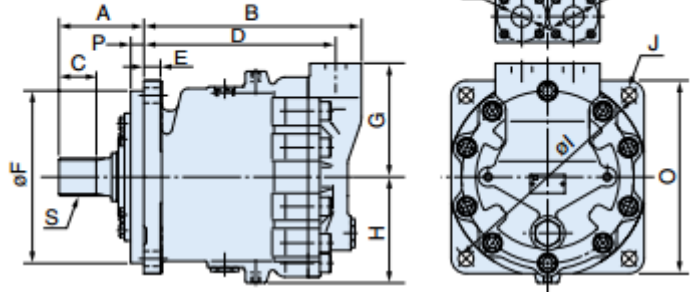

size	A	B	C	D	E	F	G	H	I	J	K	L	M	N	O	P	S
M3X530ACN	123	316	54	278.5	24	250	165	154	335	4-ø22	75	2 x 4, M12-17.5	72	30	280	19	m=2.5, z=20

oil temperature : 50°C
oil viscosity : 32mm²/s

M3X530

Mechanical efficiency (%)

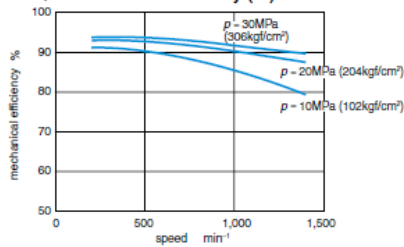

Volumetric efficiency

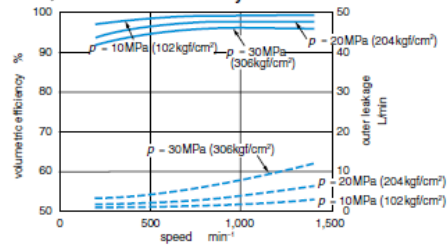

Starting mechanical efficiency

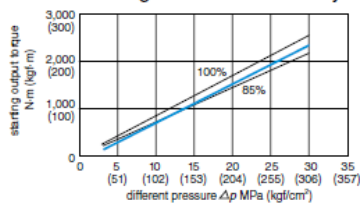

Radial load and bearing life

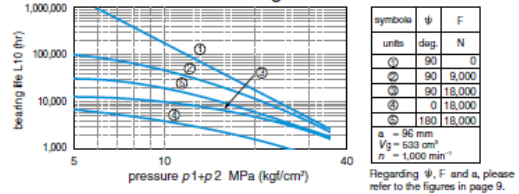

Idle & boost-graph

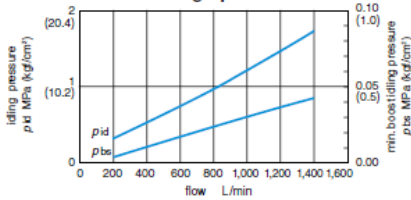

Shaft creep speed

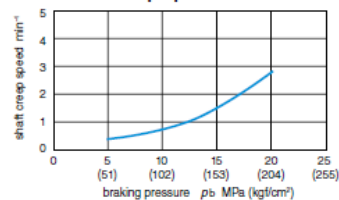

Scan QR code to
download our vCard

